

NOTES

GENERAL

1. THIS DRAWING SHALL BE READ IN CONJUNCTION WITH THE CONTRACT DRAWINGS AND SPECIFICATION
2. SERVICE SHOWN ARE FOR GENERAL LOCATION ONLY AND MAY NOT BE UP TO DATE OR COMPLETE. IT IS THE CONTRACTORS RESPONSIBILITY TO LOCATE AND PROTECT SERVICES

IRRIGATION

3. IRRIGATION SLEEVES SHALL BE INSTALLED ON THE 1.8m SERVICE ALIGNMENT UNLESS NOTED OTHERWISE. CONTRACTOR SHALL ENSURE THAT ALL DUCTS DO NOT BEGIN OR END UNDER EXISTING OR FUTURE ROAD, PATHS, WALLS OR HARD SURFACES OR IN CLOSE PROXIMITY TO EXISTING TREES
4. PIPES AND/OR CONDUITS TO BE MECHANICALLY BORED UNDER EXISTING SURFACE TREATMENTS, TREES OR ABOVE GROUND STRUCTURES
5. IRRIGATION SLEEVES TO BE INSTALLED TO A TRUE AND EVEN LINE AND GRADE
6. IRRIGATION SLEEVES INSTALLED UNDER ROAD CROSSINGS SHALL BE INSTALLED WITH 0.7m COVER AND EXTEND 10m BEYOND FACE OF KERB OR EDGE OF PAVEMENT STRUCTURE UNLESS NOTED OTHERWISE
7. PROVIDE TEMPORARY SEALS TO SLEEVE ENDS AS REQUIRED USING CAPS (NOT GLUED) OR DUCT TAPE
8. FINAL POSITION, ALIGNMENT, DEPTH, EXTENT AND METHOD OF INSTALLATION OF ALL SLEEVES MUST BE APPROVED BY THE SUPERINTENDENT BEFORE PROCEEDING WITH THE WORKS
9. THE CONTRACTOR IRESPONSIBLE FOR PROVIDING SLEEVES SHALL ENGAGE A LICENSED SURVEYOR AT HIS OR HER EXPENSE TO MEASURE AS CONSTRUCTED POSITION AND INVERT HEIGHT OF SLEEVES COORDINATED WITH PROJECT HORIZONTAL AND VERTICAL DATUMS. SURVEYOR TO PREPARE AS CONSTRUCTED DRAWING AND SUPPLY THIS TO THE SUPERINTENDENT IN BOTH AGREED HARD COPY AND AUTOCAD DWG FILE FORMATS

LEGEND

- 230 --- LIMIT OF WORKS
- LOT NUMBER
- PROPOSED ROAD
- FUTURE ROAD
- EXISTING ROAD
- PROPOSED RETAINING WALL
- EXISTING RETAINING WALL
- PROPOSED IRRIGATION SLEEVE UNDER ROAD (DETAILS TO BE PROVIDED)
- PROPOSED IRRIGATION SLEEVE UNDER WALL (DETAILS TO BE PROVIDED)
- S --- PROPOSED SEWER
- W --- PROPOSED WATER
- D --- PROPOSED DRAINAGE
- SS --- PROPOSED SUBSOIL DRAINAGE
- NBN --- PROPOSED NBN
- G --- PROPOSED NBN PIT
- G --- PROPOSED GAS
- E --- PROPOSED UNDERGROUND POWER
- L --- PROPOSED LIGHT POLE
- L --- PROPOSED LIGHT POLE & STREET SIGN
- L --- PROPOSED MINI / UNI PILLAR
- L --- EXISTING LIGHT POLE & STREET SIGN
- L --- EXISTING MINI / UNI PILLAR
- S --- SUB STATION / TRANSFORMER SITE
- Sx --- EXISTING SEWER
- Px --- EXISTING PRESSURE MAIN
- Wx --- EXISTING WATER
- Dx --- EXISTING DRAINAGE
- SSx --- EXISTING SUBSOIL DRAINAGE
- Tx --- EXISTING TELECOMMS
- NBNx --- EXISTING NBN
- Gx --- EXISTING GAS
- Ex --- EXISTING UNDERGROUND POWER
- OHx --- EXISTING OVERHEAD POWER
- Ix --- EXISTING IRRIGATION SLEEVE
- L --- STAIRWELL LOCATION
- INDICATIVE GARAGE LOCATIONS
- EXISTING TREE TO BE PROTECTED

WARNING
BEWARE OF UNDERGROUND SERVICES

The location of underground cables are approximate only and their exact position should be checked on site. No guarantee is given that all existing cables and services are shown. Locate all underground cables and services before commencement of work. Refer to Work Health and Safety (General) Regulations 2022.

BEFORE YOU DIG
www.byla.com.au

DRAWN C. STEWART	WAPC No. 163854
DESIGNED A. PANZICH	SCALE @ A1 1:500
PROJECT MANAGER R. MARTIN	DATUM AHD
JDSI PROJECT No. JDS232197.01B	CO-ORDS MRCG2020
DRAWING No. C600	REVISION 0

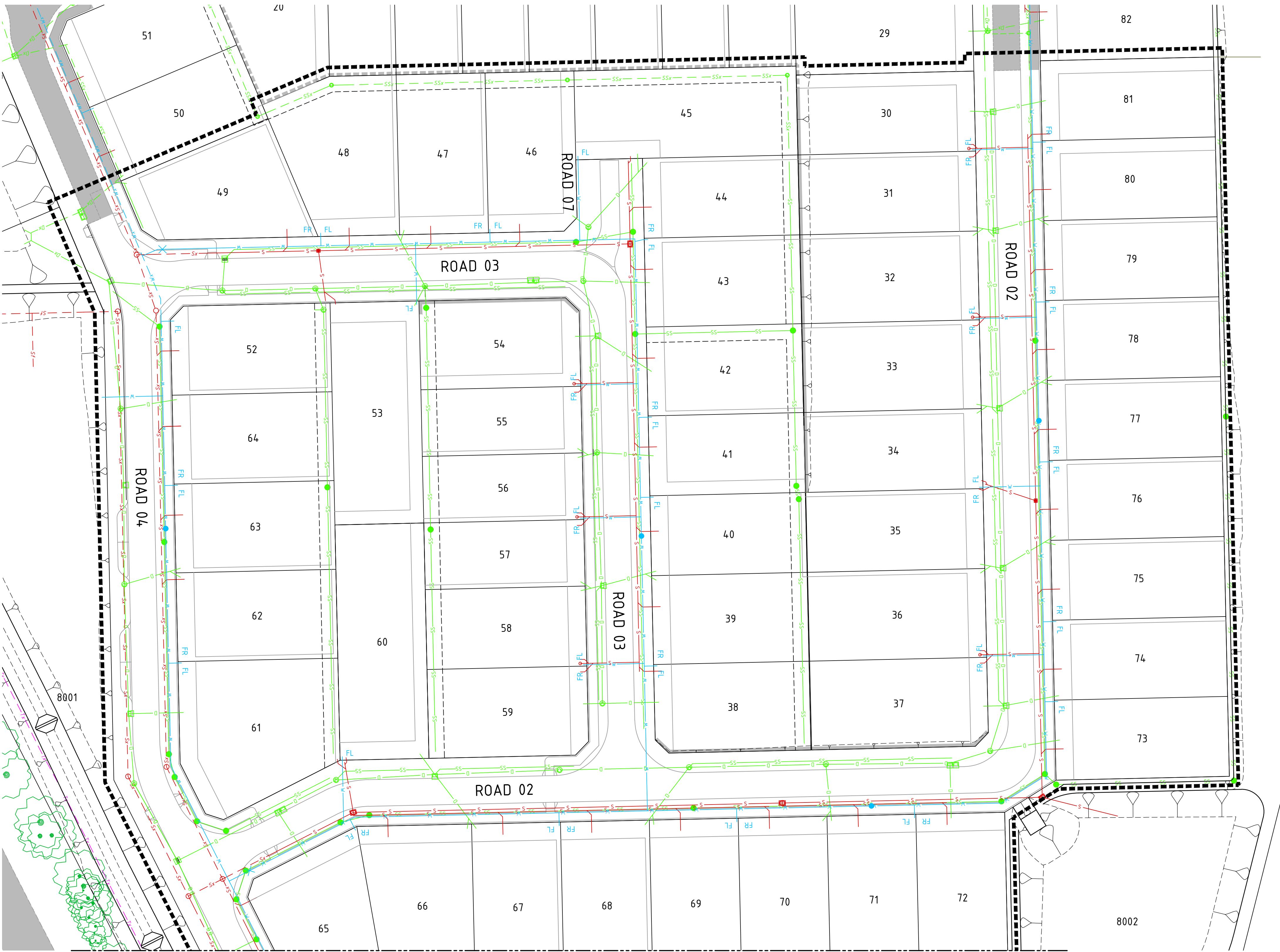

MATCHLINE REFER DRG C601

0 5 10 20 30m
SCALE 1:500 @ ORIGINAL SHEET SIZE A1

REV	DATE	DRAWN	CHECKED	APPROVED	DESCRIPTION
0	16.10.24	CS	RF	RF	ISSUED FOR CONSTRUCTION
B	04.09.24	AP	RF	RF	RE-ISSUED FOR COUNCIL APPROVAL
A	15.05.24	AP	RF	RF	ISSUED FOR COUNCIL APPROVAL

COPYRIGHT
This drawing is copyright and the property of JDSi Pty Ltd (JDSi). Use without written permission from JDSi constitutes an infringement of copyright.
This document and the information are solely for the use of the authorised recipient and may not be used, copied or reproduced in whole or part for any purpose other than that for which it was supplied by JDSi.

NOTE
This drawing shall be preliminary only until it is issued for construction.
Certified Quality System to ISO 9001

JDSi
CONSULTING ENGINEERS

CLIENT:
YOLK PROPERTY GROUP

ARBOUR
MARGARET RIVER

PROJECT:
LOT 9000 BUSSELL HIGHWAY
MARGARET RIVER STAGE 1B

DRAWING TITLE:
COMPOSITE SERVICES PLAN
SHEET 1

NOTES
GENERAL
1. THIS DRAWING SHALL BE READ IN CONJUNCTION WITH THE CONTRACT DRAWINGS AND SPECIFICATION
2. REFER TO DRAWING JDS232197.01B_C600 FOR NOTES AND LEGEND.

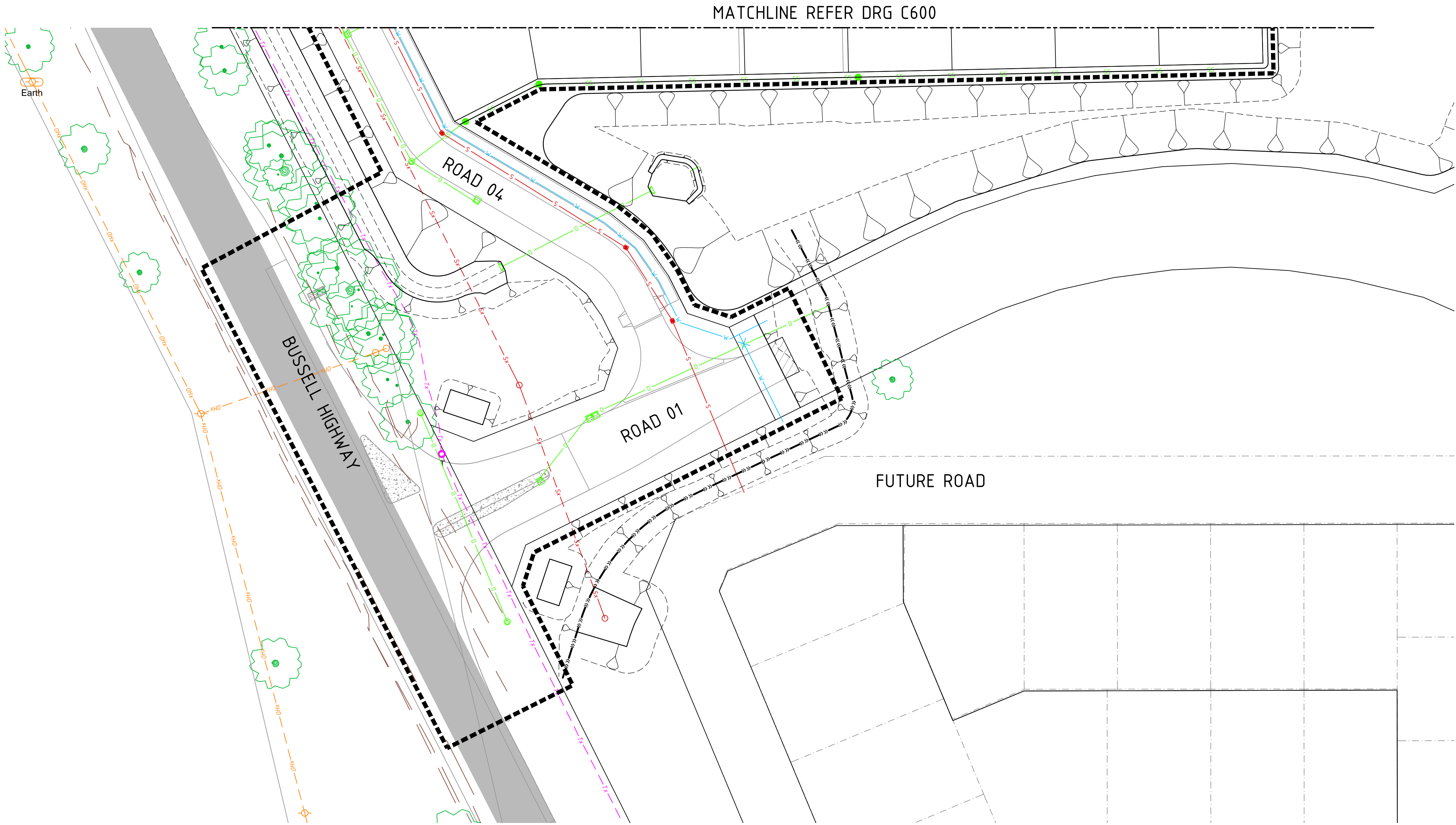

0 5 10 20 30m
SCALE 1500 @ ORIGINAL SHEET SIZE A1

WARNING
BEWARE OF UNDERGROUND SERVICES

The location of underground cables are approximate only and their exact position should be checked on site. No guarantee is given that all existing cables and services are shown. Locate all underground cables and services before commencement of work. Refer to Work Health and Safety (General) Regulations 2022.

BEFORE YOU DIG
www.byda.com.au

0	16.10.24	CS	RF	RF	ISSUED FOR CONSTRUCTION	
B	04.09.24	AP	RF	RF	RE-ISSUED FOR COUNCIL APPROVAL	
A	15.05.24	AP	RF	RF	ISSUED FOR COUNCIL APPROVAL	
REV	DATE	DRAWN	CHECKED	APPROVED		

COPYRIGHT
This drawing is copyright and the property of JDSi Pty Ltd (JDSi). Use without written permission from JDSi constitutes an infringement of copyright.
This document and the information are solely for the use of the authorised recipient and may not be used, copied or reproduced in whole or part for any purpose other than that for which it was supplied by JDSi.

NOTE
This drawing shall be preliminary only until it is issued for construction.
Certified Quality System to ISO 9001



CLIENT:
YOLK PROPERTY GROUP
ARBOUR
MARGARET RIVER

PROJECT:
LOT 9000 BUSSELL HIGHWAY
MARGARET RIVER STAGE 1B
DRAWING TITLE:
COMPOSITE SERVICES PLAN
SHEET 2

DRAWN C. STEWART	WAPC No. 163854
DESIGNED A. PANZICH	SCALE 1:500
PROJECT MANAGER R. MARTIN	DATUM AHD
JDSi PROJECT No. JDS232197.01B	CO-ORDS MRCG2020
DRAWING No. C601	REVISION 0